



MESSE ESSEN

HYGIENE CONCEPT

OUR GUIDANCE FOR VISITORS
TO OUR TRADE FAIRS

MESSE
ESSEN

YOUR SAFETY IS OUR MAIN PRIORITY

We are delighted to be able to welcome you back to Messe Essen and are implementing a range of measures to ensure a safe trade fair experience for everyone.

For your safety, we constantly adapt our proven hygiene and protection concept to any changes in the Coronavirus Protection Ordinance of the State of North Rhine-Westphalia.

This brochure shows you at a glance what protective measures apply when you attend a trade fair at Messe Essen and how you can protect yourself and other visitors. Our aim is to ensure your safety and well-being during your time here.

We appreciate your collaboration in preparing for your trade fair visit and complying with the hygiene measures.

Enjoy your visit.

With thanks from your Messe Essen team

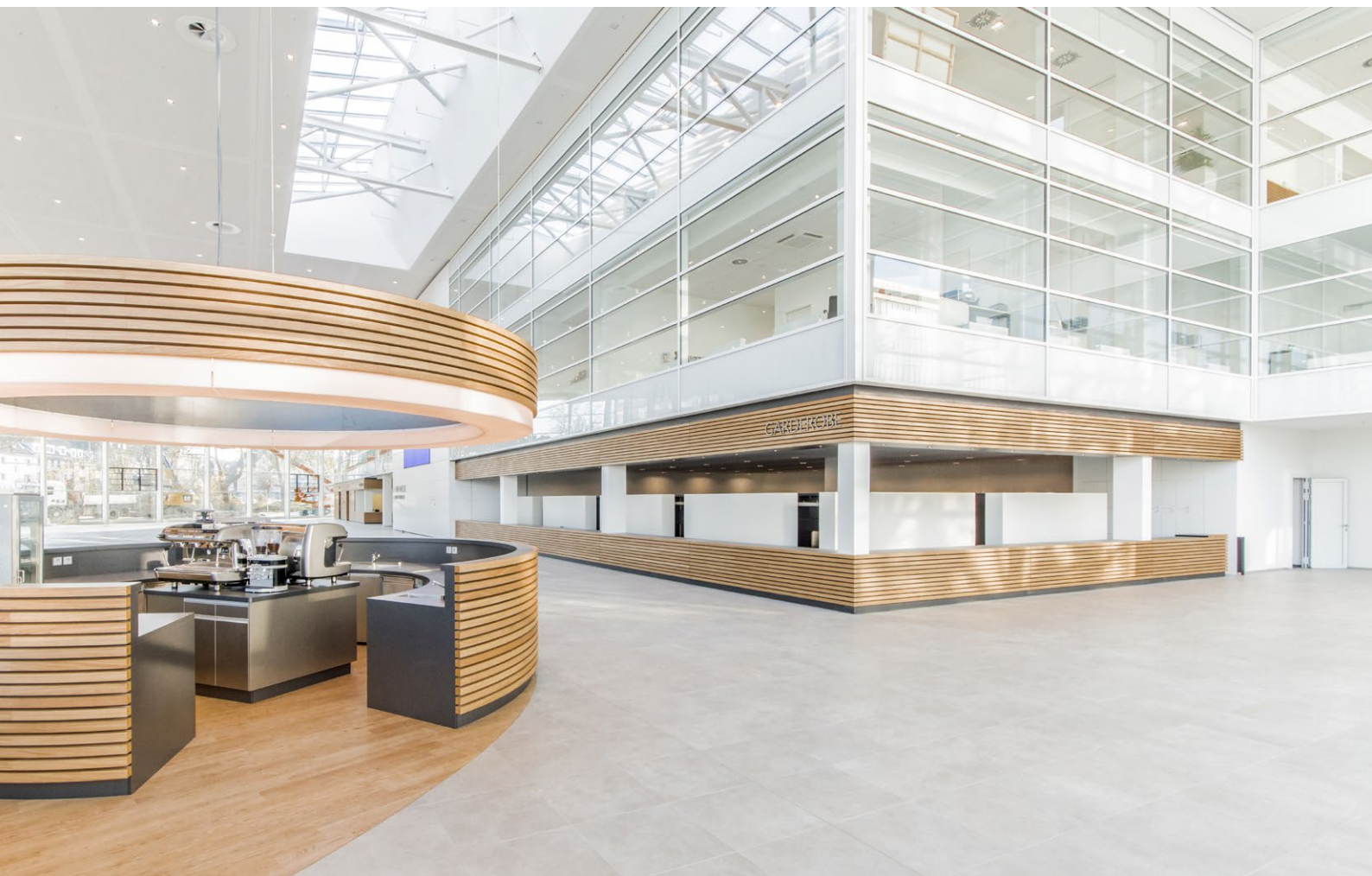

SAFETY RIGHT FROM THE START

ENTRY REQUIREMENTS FOR OUR TRADE FAIRS



You will only be granted entry to our trade fairs if you have proof of vaccination, testing or recovery, as outlined below:

- You have been vaccinated against COVID-19 in accordance with section 2 of the Coronavirus Protection Ordinance and can provide valid documentary proof of this at the entrance to the trade fair site on the day you are attending an event;
- You have recovered from a COVID-19 infection and can provide documentary proof of a positive PCR test (or other nucleic acid test) that was performed at least 28 days but no earlier than 6 months ago;
- You can provide proof of a negative test in accordance with section 2 of the Coronavirus Protection Ordinance at the entrance to the trade fair site on the day you are attending an event.

Please have the requisite proof (vaccination, test, recovery) in a digital format that is suitable for scanning with the CovPassCheck app.

TICKET PURCHASE AND ACCESS CONTROL



To avoid delays and make registration as easy as possible, please purchase your admission ticket online in advance.



Access to the exhibition centre is a two-stage process. To start with, your proof of vaccination, testing or recovery (see above) will be checked outside the entrance. Please have this proof ready for checking. Proof of identity (photographic identity document such as passport, ID card or driving license) will be checked on a random basis.

Your ticket will then be scanned at the entrance to the exhibition halls. Our Hygiene Scouts will be on hand during this process to answer any questions you may have.

WE'RE READY TO WELCOME YOU

ENSURING YOUR SAFETY AT THE EXHIBITION CENTRE



Our doors are open to you, with separate entrances and exits to ensure your safety.



Cashless and contact-free payment (e.g. of parking tickets or in restaurants) is possible.



Transparent screens, broad aisles and generously designed exhibition spaces and meeting booths create a safe atmosphere, making it easy for you to comply with hygiene measures and keep your distance from other visitors. In addition, we work with our exhibitors to ensure that contact surfaces such as counters, tables and door handles as well as our toilet facilities are cleaned regularly.



We have installed a large number of hand sanitiser dispensers and hand-washing facilities throughout the site.



Our state-of-the-art ventilation systems reduce the number of pathogens in the air inside the exhibition centre. Open doors to the outside also ensure fresh air inside the buildings.



Our restaurants apply the general rules for the catering sector that you are familiar with. These include being able to remove your surgical face mask once you are seated and registering your contact details.

WE NEED YOUR HELP

HYGIENE AND PROTECTIVE MEASURES FOR EVERYONE

The Messe Essen hygiene concept consists of simple measures that everyone can implement in order to protect themselves and others. Our large team of Hygiene Scouts is out and about during events at the exhibition centre. Please speak to one of them if you have any questions or comments about our hygiene concept. The Hygiene Scouts are there to keep you safe by ensuring that everyone complies with the hygiene rules and that no crowds gather, for example.



For the protection of all visitors, surgical face masks must be worn in the exhibition halls.

There are exceptions:

- In outdoor spaces
- When seated at stands and restaurants or Coffee Points



Please wash and disinfect your hands thoroughly at regular intervals. You will find hand sanitiser dispensers throughout the site.



Please cough and sneeze into the crook of your arm or use a tissue.